

NO.	DESCRIPTION
1	HIDDEN END CAM (UNIVERSAL CLAMP)

HIDDEN END CAM (UNIVERSAL CLAMP)		
SIZE: <b>A</b>	DO NOT SCALE DRAWING	
SCALE:1:1	WEIGHT: 0.17 LBS	SHEET 1 OF 1

## Installation

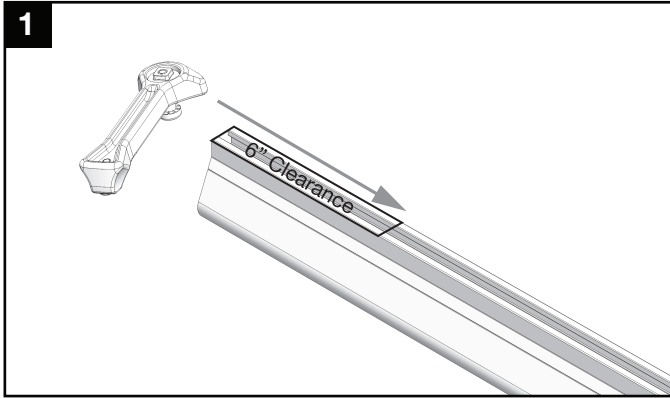

Slide CAMO® into rail channel far enough to clear the module frame. CAMO® requires 6" of clearance from end of rail.

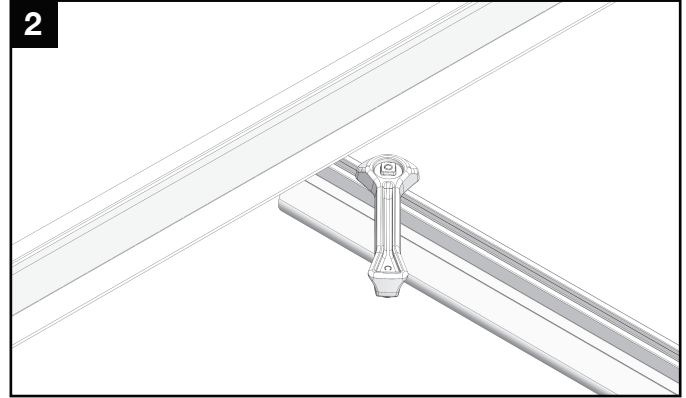

Place module on rails (module cells not shown for clarity).

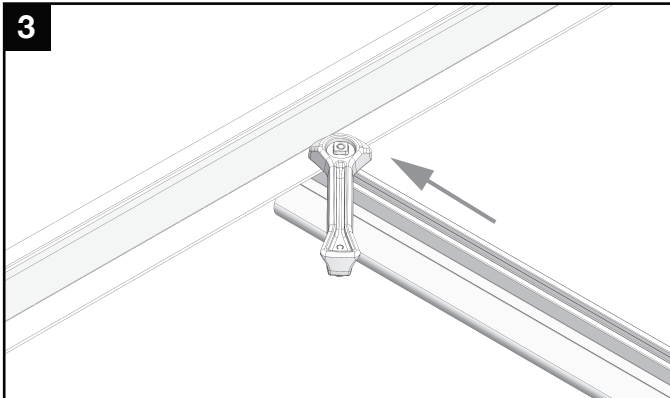

Pull CAMO® towards rail ends, at 45 deg angle, so the bonding bolt contacts the module flange edge.

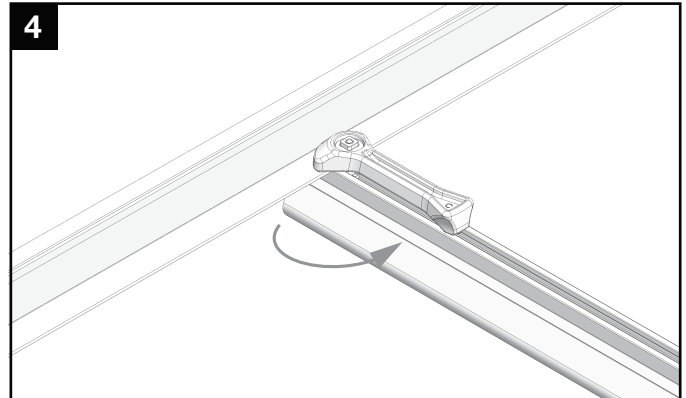

Rotate handle with an upwards motion until CAMO® snaps into rail channel. Ensure Camo bonding pins are fully seated on top of module frame.

## Module Compatibility and Certifications

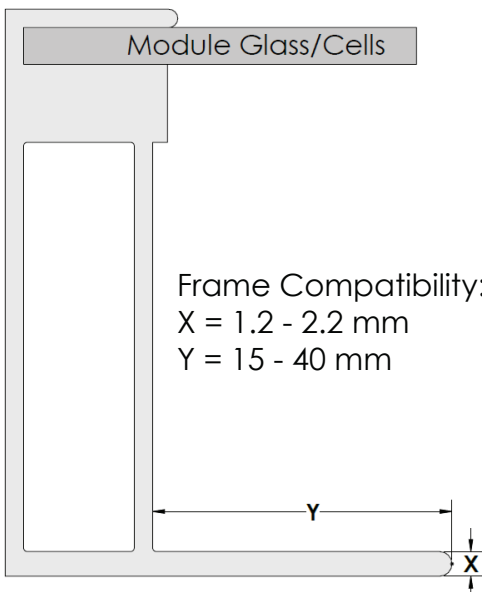

### UL 2703

Conforms to STD UL 2703 (2015) requirements. See IronRidge® Flush, Tilt, or Ground Mount Manuals for full ratings and list of compatible modules.